

## SIDE SWING FRICTION STAY 21195

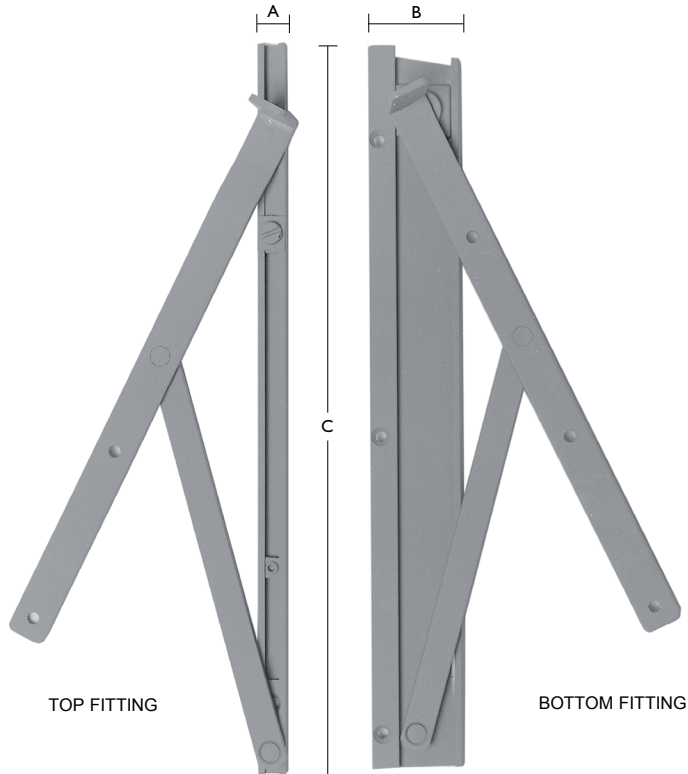

BJ Waller part no.	IpPA Part No.	Hand	A mm	B mm	C mm
1.81806	21195/18211	RH	12	40	314
1.81906	21195/17211	LH	12	40	314

- Convenient for cleaning
- Swings 90°
- Opens clear from curtains and window frame
- Max. Ventilation
- Concealed fittings
- Friction in all positions
- Adjustable friction
- Anodized aluminium rails
- Easy to operate
- Easy to fit
- Electroplated steel parts

Max. Weight of sash: 40kg  
 Min. Width of sash: 320mm  
 Max. Width of sash: 820mm  
 Screw no: 4

**SIDE SWING WINDOWS**



**SIDE SWING FRICTION STAY 21195**

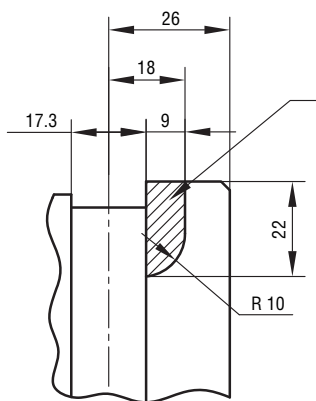
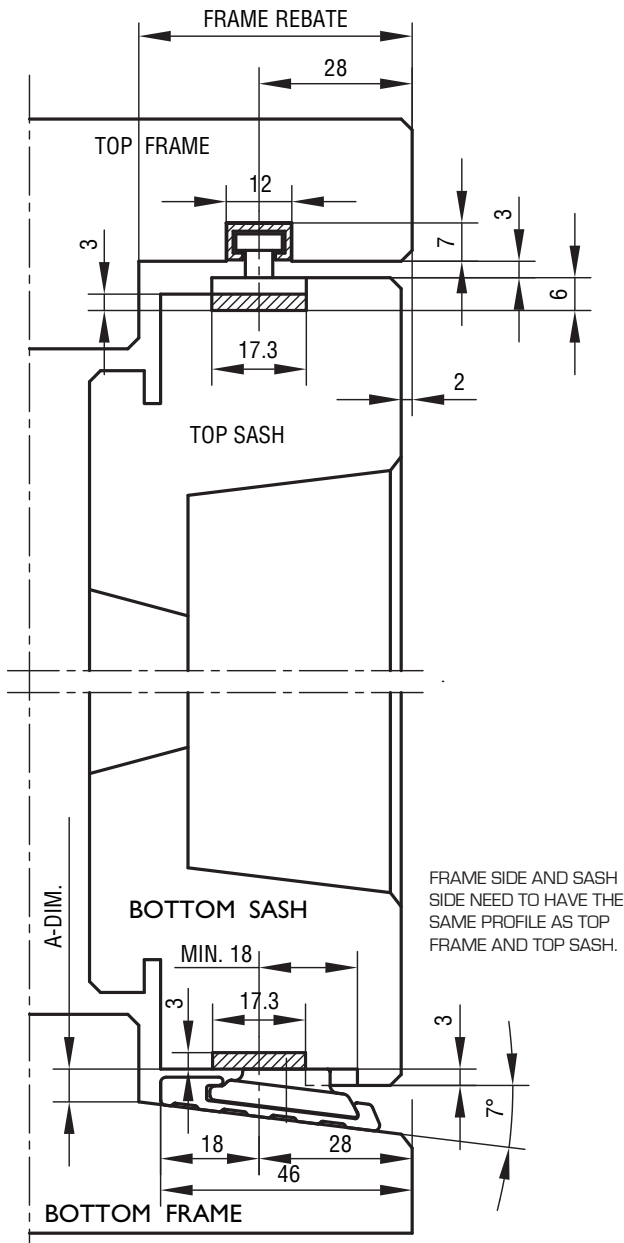

EXTRA CUT OUT IN SASH FROM UNDERNEATH. THE SLOT ROUTERED OUT MUST HAVE A WIDTH OF 22 X 9 MM AND A DEPTH OF 3 MM.

FRAME REBATE	A-DIM.
46	6,5
50	6,0
54	5,5

**Important:**

When manufacturing the window and mounting the fittings the sliding shoes need to be in centre position in the Aluminium profile, this enables the window to work. When mounting the window the top and bottom frame should be parallel. This is necessary, in order to let the sliding shoes glide without friction in the aluminium profile.

**Fitting:**

1. The friction hinges should be positioned in the grooves at the head and cill of the frame and then screwed in place.
2. Push the window sash into position by sash slots and fasten the screws.
3. The friction can be adjusted by the nylon screw on the top fitting.
4. If a larger opening angle is required then move the adjustable stop fitting in the top frame Aluminium rail.

**Maintenance:**

The fittings are not to be painted. Test the operation from time to time. When fitting - grease the pivot/movable metal parts of the mechanism while activating repeatedly. Thereafter grease minimum twice a year. Do not grease the Aluminium rails.

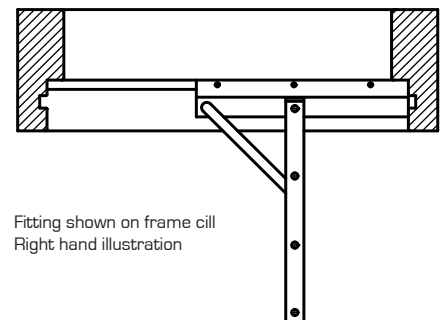

Fitting shown on frame cill  
Right hand illustration



## SIDE SWING FRICTION STAY 21193

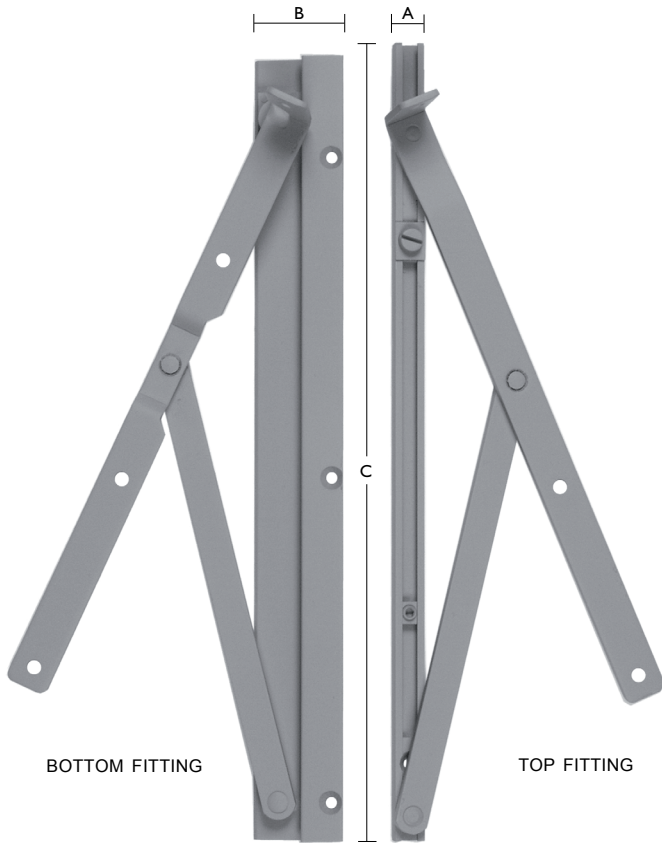

BJ Waller part no.	IpPA Part No.	Hand	A mm	B mm	C mm
1.82706	21193/18211	RH	12	36	313
1.82806	21193/17211	LH	12	36	313

- Convenient for cleaning
- Swings 90°
- Opens clear from curtains and window frame
- Max. Ventilation
- Concealed fittings
- Friction in all positions
- Adjustable friction
- Anodized aluminium rails
- Easy to operate
- Easy to fit
- Electroplated steel parts

Max. Weight of sash: 40kg  
 Min. Width of sash: 320mm  
 Max. Width of sash: 820mm  
 Screw no: 4

**SIDE SWING WINDOWS**



**SIDE SWING FRICTION STAY 21193**

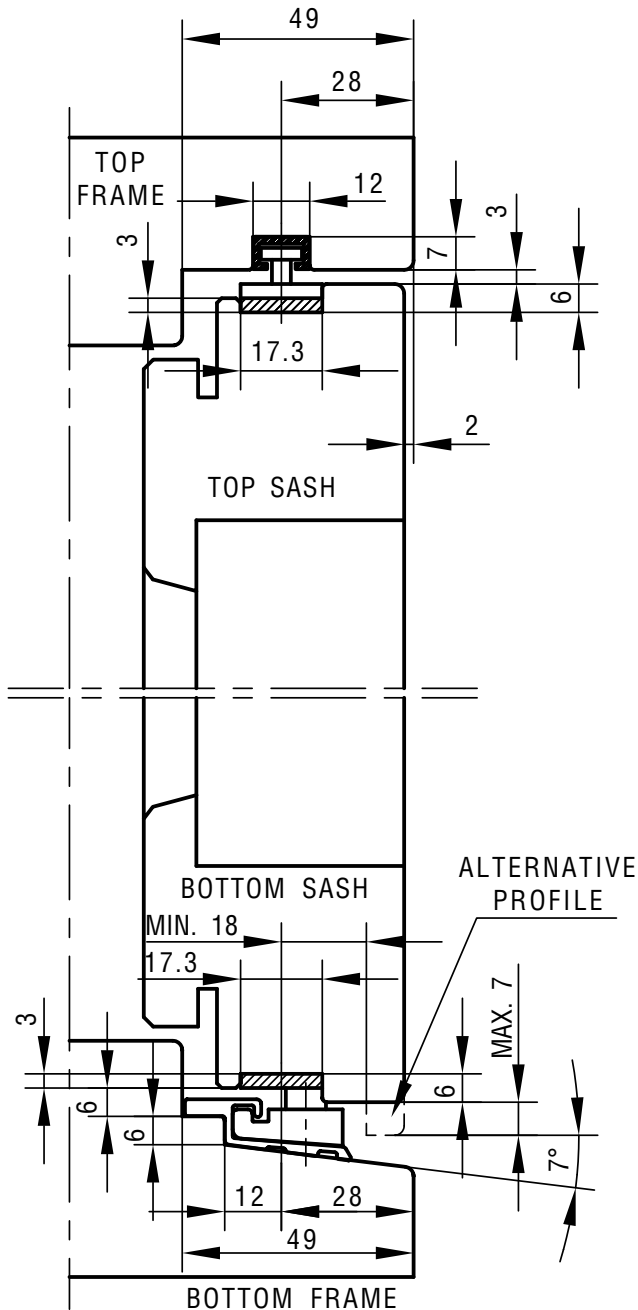

**Important:**

When manufacturing the window and mounting the fittings the sliding shoes need to be in centre position in the Aluminium profile, this enables the window to work. When mounting the window the top and bottom frame should be parallel. This is necessary, in order to let the sliding shoes glide without friction in the aluminium profile.

**Fitting:**

1. The friction hinges should be positioned in the grooves at the head and cill of the frame and then screwed in place.
2. Push the window sash into position by sash slots and fasten the screws.
3. The friction can be adjusted by the nylon screw on the top fitting.
4. If a larger opening angle is required then move the adjustable stop fitting in the top frame Aluminium rail.

**Maintenance:**

The fittings are not to be painted. Test the operation from time to time. When fitting - grease the pivot/movable metal parts of the mechanism while activating repeatedly. Thereafter grease minimum twice a year. Do not grease the Aluminium rails.

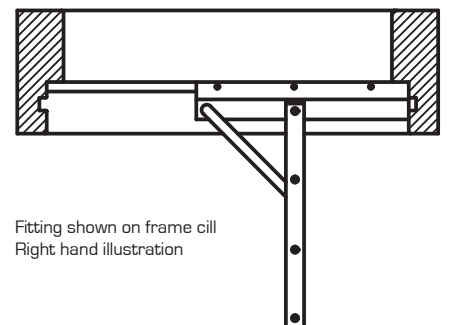

Fitting shown on frame cill  
Right hand illustration