

F24-908W CENTRE KEEP ANC U LH SILVER

4936175

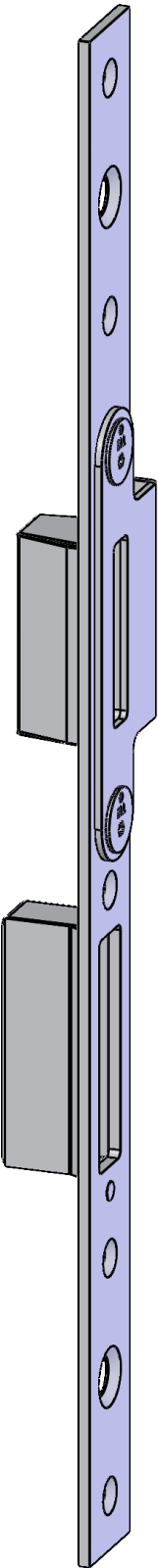

Product details	
Product base class	Frame parts
Product function group	Single keep
Product group	Main locking system keep
Product	Latch-deadbolt with adjustment

Specification	
Frame profile	F24-908
Type of faceplate frame part	Flat faceplate
Faceplate width frame part	24 mm
Faceplate end frame part	Angular
Version/Length	Standard
Contact pressure frame part	Standard
Locking plate	Locking plate angled FAW 17,5 mm
Trigger	Not retrofittable
Latch ramp bridge	Without latch ramp bridge
Bolt type frame part	1 x Latch-deadbolt
Adjustment auxiliary locking point	Without adjustment
DIN Direction	DIN left-hand
Surface	Matchrome-plated MC
Pocket	With pocket
End cap	Without end cap
Anchor hole	Anchor hole 9,2 mm
Type of fixing	Standard hardware screw

F24-908W CENTRE KEEP ANC U LH SILVER 4936175

F24-908W CENTRE KEEP ANC U LH SILVER 4936175

Legend

The Winkhaus Portal

A simple click on the article number takes you directly to the article in the Winkhaus Portal. Further information such as a product description or explanations of the individual specifications are available in the Winkhaus Portal. Further information is also provided for the various profile systems, such as the sash and frame numbers. Additional documents and images for the selected product are also available in the download area.

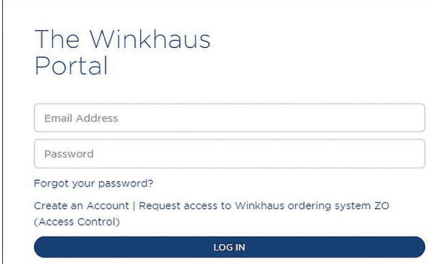

The Winkhaus Portal

Email Address

Password

[Forgot your password?](#)

[Create an Account](#) | [Request access to Winkhaus ordering system ZO \(Access Control\)](#)

LOG IN